

EXPLOSION PARTS & LIST

CT-20DXQD and CT-20DXQS

Numbers with * applies only to CT-20DXQS (Dirt Sensor) parts.

DIAGRAM #	STOCK #	DESCRIPTION
8	40713	SCREW
9	40724	MOTOR GASKET
10	40999	BELT
11	40284	MOTOR SPRING
12	41010	LOWER PLATE
13	41021	MOTOR
14	40317	MOTOR BRIDGE
15	41032	OVERLOAD PROTECTOR
16	39943	LIGHT BULB
17	41043	BULB SOCKET
18	40339	HANDLE RELEASE PEDAL
19	40350	SWIVEL
*19	41131	SWIVEL
21	40768	WIRE CONNECTOR
22	40383	SWIVEL SEAL
23	41054	WHEEL
24	40405	PEDAL EASY RELEASE
*24	41142	PEDAL EASY RELEASE
25	40416	REAR COVER
*25	41153	REAR COVER
26	40427	FRONT AXLE ASSEMBLY
27	41065	AGITATOR UNIT
28	40801	INDICATOR WINDOW
29	41076	LIGHT LENS
30	40823	EXHAUST FOAM
31	41087	WINDOW REFLECTOR
32	40460	CORD & PLUG ASSEMBLY
*32	41164	LEAD WIRE UNIT
33	41098	REFLECTOR NOZZLE
34	41109	NOZZLE HOUSING (DECO)
*34	41252	NOZZLE HOUSING (DECO)
35	40867	SWIVEL CAP
36	40878	CAM INDICATOR
*37	41186	FRONT COVER
*38	41197	PCB "B" UNIT
*39	41208	SCREW
*40	41263	PCB DIRT SENSOR
41	41120	LEAD WIRE
42	40570	INDICATOR LEVER
43	40581	PAD FOOT PEDAL
44	40592	INDICATOR BLOCK
45	40603	SPRING ASSIST
*46	41230	WINDOW DIRT SENSOR
47	40625	LIFTER
*48	41241	SCREW
*49	41274	PCB SUPPORTER
50	40889	THRUST WASHER
51	40900	CATCH INDEXING
52	40911	WASHER
53	40922	RATCHET CATCH
54	40933	INDICATOR BLOCK ASSEMBLY
55	40944	SCREW

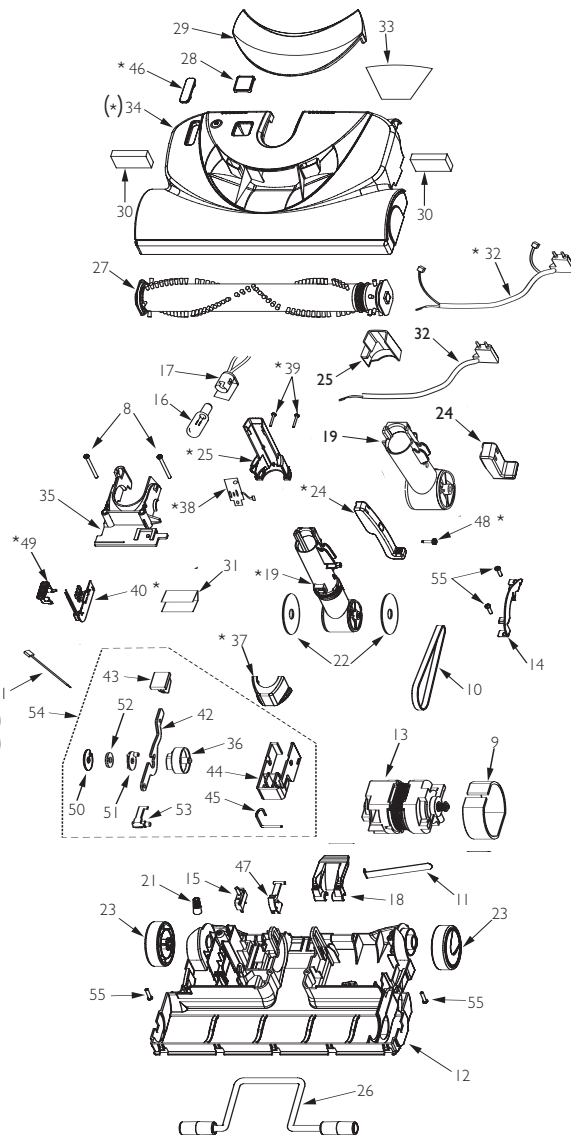

CT-20DXQD & CT-20DXQS Electric Brush Manual

SAFETY INSTRUCTIONS

Please read all instructions before using this Electric Powerhead.



Electric shock could occur if used out doors or on wet surfaces.

- 1) Unplug and disconnect power before servicing.
- 2) Always turn off this appliance before connecting or disconnecting either hose or motorized nozzle.
- 3) Do not pick up anything that is burning or smoking, such as cigarettes, matches, or hot ashes.
- 4) Use only as described in this manual. Use only manufacturers recommended attachments.
- 5) Do not unplug by pulling on cord. To unplug, grasp plug, not the cord.
- 6) Do not handle system or appliances with wet hands.
- 7) Turn off all controls before unplugging.
- 8) Do not use with damaged cord or plug. If appliance is not working as it should, has been dropped, damaged, left outdoors, or dropped into water, return it to distributor.
- 9) Do not allow to be used as a toy. Close attention is necessary when used by or near small children.
- 10) The hose contains electrical wires. Do not use if damaged, cut or punctured. Avoid picking up sharp objects.
- 11) Do not put any object into openings.
- 12) Do not use with any opening blocked; keep free of dust, lint, hair, and anything that may reduce air flow.
- 13) Keep hair, loose clothing, fingers, and all parts of the body away from openings and moving parts.
- 14) Do not leave vacuum or brush when plugged in. Unplug from outlet when not in use and before servicing.
- 15) Do not pick up flammable or combustible liquids such as gasoline or use it in areas where they may be present.
- 16) Use extra care when cleaning on stairs.

Save These Instructions.

INTENDED FOR HOUSEHOLD USE ONLY.

DIRT SENSOR

Some Models

The dirt sensor light system is mounted on the CT-20DXQS nozzle near the reset button. It consists of a series of two red lights and two green lights.

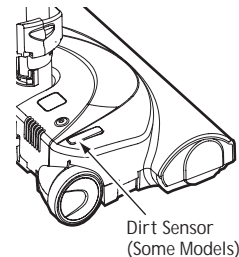

Initial Start Up

When the CT-20DXQS is first started, the following sequences occurs in a two second time frame:

- 1) Two red lights come on.
- 2) Two green lights come on.
- 3) Two green lights remain on until the CT-20DXQS nozzle is placed in use.

In Operation

When the CT-20DXQS is being moved back and forth on the floor, the lights will change from one configuration to another as more or less dirt is being vacuumed. As long as the red lights are on, dirt is passing through the wand indicating that the surface still needs cleaning.

When the green lights stay on as the CT-20DXQS is moved back and forth over an area, the sensor is not seeing enough dirt to warrant further cleaning of that area.

Cleaning Lens

Although the dirt sensor feature in your CT-20DXQS is designed for years of trouble free use, the passage of dirt through the air passage system can coat the lens causing the green light to come on and stay on - never switching to red. When this happens the lens must be cleaned.

To Clean The Lenses

Note:
DO NOT attach or remove handle or wands while cleaner is ON.

- 1) Remove the wands by pressing the easy release pedal and lifting up on the wands.

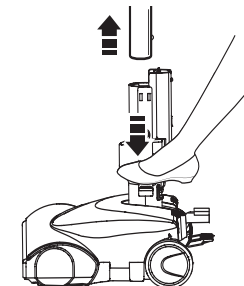

- 2) As indicated by the illustration below, the two dirt sensor elements are located on the inside of the swivel, approximately 3 1/2" (90mm) down, (note the arrows). Each element should be cleaned periodically. To reach the sensor elements, use a small brush such as a bottle brush. Brush each sensor element several times to remove dust and dirt.

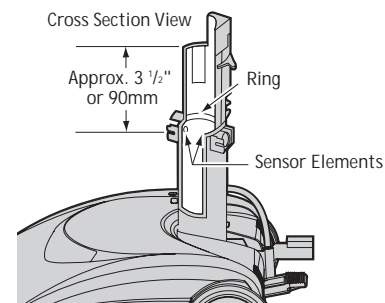

Note:
Looking down inside the swivel you will see a ring. The sensor elements are located just slightly below this ring.

- 3) Reinstall the wands after cleaning the sensors.



Never use water or any cleaning solution when cleaning the lenses. The residue of the water or cleaners will accelerate the recoating of the lenses and make cleaning necessary sooner.

AGITATOR SERVICING



WARNING

Electrical Shock or Personal Injury Hazard

Disconnect electrical supply before servicing or cleaning the unit. Failure to do so could result in electrical shock or personal injury from cleaner suddenly starting.

To Check Agitator Assembly:

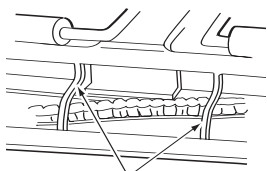

Base Support Bars

When brushes are worn to the level of the base support bars, replace the agitator assembly.

To Replace Agitator Assembly:

- 1) Remove the POWERHEAD cover, belt and agitator assembly. See "To Remove Belt" in BELT CHANGING AND AGITATOR CLEANING.
- 2) Reinstall belt, new agitator assembly, and POWERHEAD cover. See "To Replace Belt" in BELT CHANGING AND AGITATOR CLEANING.

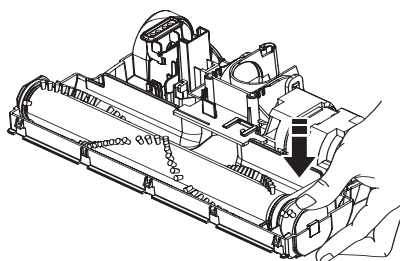

FEATURES

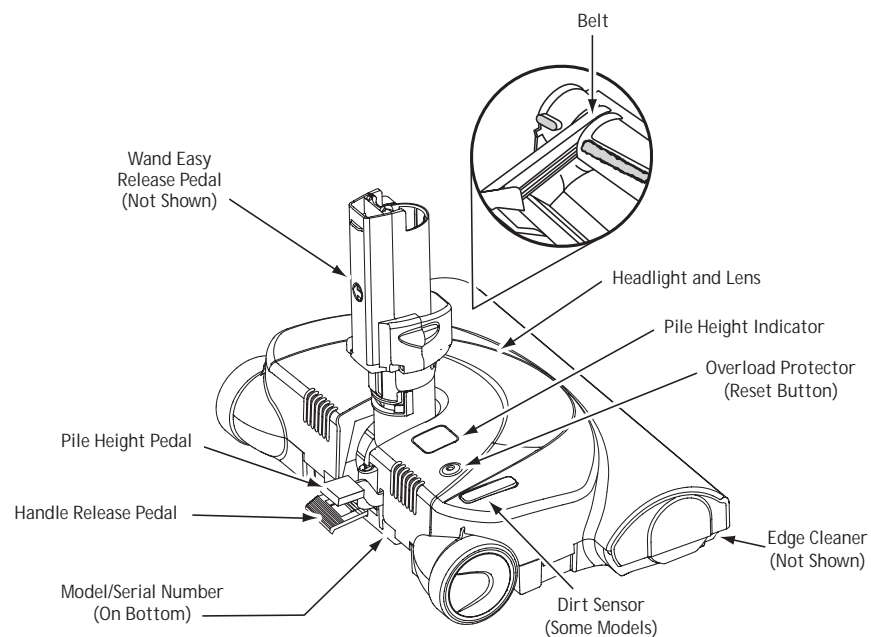

SPECIAL FEATURES

Edge Cleaner

Active brush edge cleaners are on both sides of the POWERHEAD electric brush. Guide either side of the brush along baseboards or next to furniture to help remove dirt trapped at carpet edges.

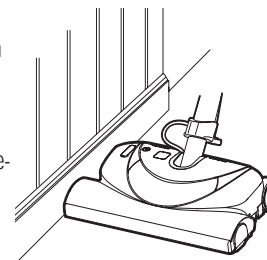

Overload Protector

The overload protector protects the motor from brush jamming and belt breakage. If the agitator slows down or stops, the overload protector shuts off the brush.

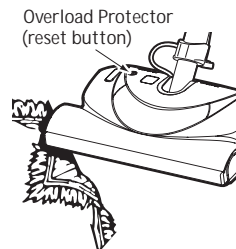

To correct problem: Unplug the electrical cord, remove obstruction. Check brush area for excessive lint buildup or jamming.

To reset: Press the reset button on top of the brush. Plug in the power cord, turn on vacuum and brush.

WANDS & ATTACHMENTS

Telescoping Wand

The wand length is adjustable and requires no assembly. To adjust, simply push down on the wand adjust button and slide the upper wand to the desired height.

The swivel, located on the POWERHEAD allows you to turn the handle to the left side to reach farther under low furniture.

When raising the wand you may have to hold the POWERHEAD with your hand or foot.

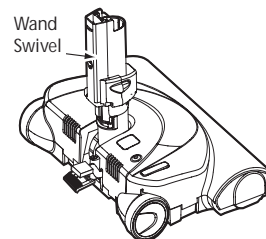
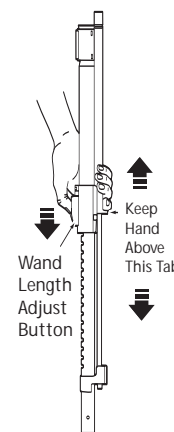

WARNING

DO NOT attach or remove handle or wands while cleaner is ON. This could cause sparking and damage the electrical contacts.

Wand Attachment

1. To remove wands from the POWERHEAD, lock wands in straight-up position.
2. Press wand easy release pedal with foot and pull the wands straight up out of the POWERHEAD. The plug and cord do not have to be removed to use attachments on the wands.

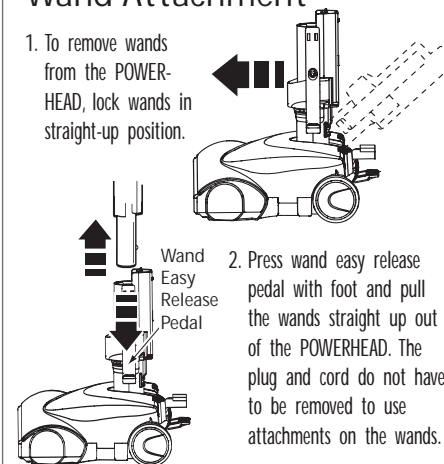

PILE HEIGHT SETTINGS

Suggested pile height settings:

For best deep down cleaning, use the XLO setting. However you may need to raise the height to make some jobs easier, such as scatter rugs and some deep pile carpets, and to prevent the vacuum cleaner from shutting off.

As a general guide:

XLO — most carpet heights MED — medium to long pile
LO — short to medium pile HI — shag and long pile

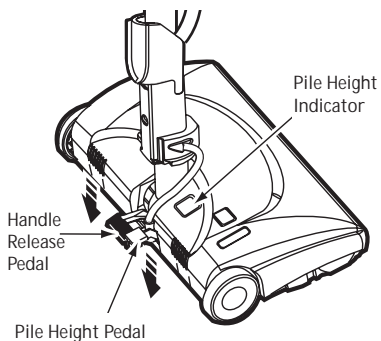

ELECTRIC BRUSH CARE

Always follow all safety precautions when cleaning and servicing the POWERHEAD.



WARNING

Electrical Shock or Personal Injury Hazard

Disconnect electrical supply before servicing or cleaning the unit. Failure to do so could result in electrical shock or personal injury from cleaner suddenly starting.

Belt Changing and Agitator Cleaning

Disconnect cleaner from electrical outlet. Frequently check and remove hair, string and lint buildup in brush area. If buildup becomes excessive, disconnect the brush from wand and follow steps below.

To Remove Belt:

- 1) Turn the POWERHEAD upside down.
- 2) Unscrew the brush cover screws.

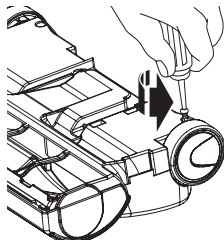

- 3) Turn the POWERHEAD right side up. Press handle release pedal and lower the swivel. To remove cover, grasp the sides and pull out to release the outside of the cover.

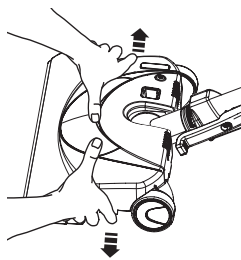

- 4) Lift rear latches up and tilt cover forward from back until front snaps free.

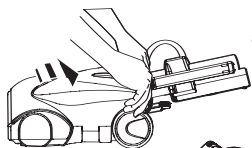

- 5) Lift agitator assembly out, remove worn belt and clear any hair, string or lint build-up from brush area.

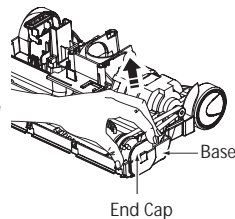
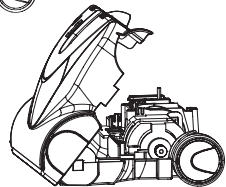

ELECTRIC BRUSH CARE

To Replace Belt:

- 1) Install new belt over motor drive, then over brush sprocket.

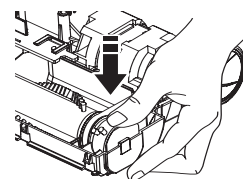
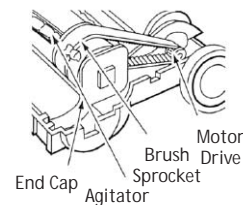

- 2) Replace agitator assembly back into the POWERHEAD.

- 3) Line up front of cover and base. Rest cover on front edge of base as shown.

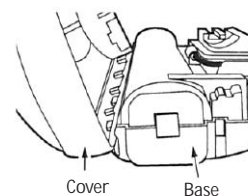

- 4) NOTE: On dirt sensor models be sure that the board is upright and the wires are tucked back as shown.

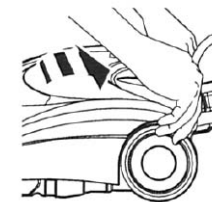

- 5) Tilt cover to back. Press cover firmly until side and rear tabs snap into place. Turn the POWERHEAD upside down and replace the 2 cover screws.

LIGHT BULB CHANGING

- 1) Remove the POWERHEAD cover as shown in BELT CHANGING AND AGITATOR CLEANING section.

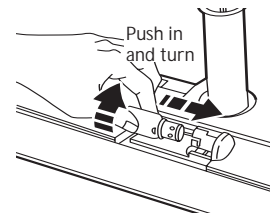

- 2) Push in and turn bulb counterclockwise, then pull out to remove.

- 3) Push in and turn the bulb clockwise, to replace. Bulb must not be higher than 130 volts/15 Watts.

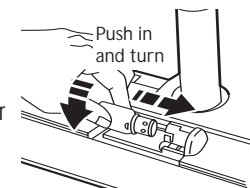

- 4) Reinstall the POWERHEAD cover as shown in BELT CHANGING AND AGITATOR CLEANING section.